

## **BIGGER, FASTER, BETTER**

The World Cup arrives in Qatar,  
as TransDev reveals its own  
**BIG INVESTMENTS**

### **In this issue**

**NEW KEY STEELS & PARALLEL KEYS**  
**PLASTICS GETS PERSONAL**  
**SYNCHROCHAIN CARBON TAKES CHARGE**  
**DRIVEFLEX BEARINGS**

**FREE  
INSIDE**

**2023 WALL  
PLANNER**

**PLUS WORLD CUP  
WALL CHART!**





# Investing in the Future

TransDev's T3 building has grown into a Technical Centre offering 'state of the art' services to the wider business and beyond.

## Surface Finishing

TransDev has invested in a state of the art plating unit to bring yet another sub-contract operation in house.

This will provide us with even more flexibility and control over jobs that would previously require sending out on potentially long lead times. A Plater with over 20 years of plating experienced has been recruited to run the plant, which has been fully specified in conjunction with the plating chemical company. Capacity, extraction and safety measures also go beyond current requirements, as we look to future proof the facility.

### Aluminium Anodising (HE30)

- Clear Suplphuric Anodise
- Colour Anodise
- Hard Anodise
- Anodise Sealant

### Carbon Steel Plating

- Zinc Plating
- Clear Passivation
- Colour Passivation
- Chemi Blacking



## Waterjet Cutting

The Swift-Jet Pro waterjet cutting table combines the ability to cut a wide range of materials with exceptional precision and reproducibility. It will be utilised across the TransDev business to;

- Cut Pulley/Sprocket lightening holes
- Cutting Transback backing materials
- Machining plastics



### The waterjet cutting table offers many advantages

Water and abrasive can be used to cut a wide range of materials

Large cutting area  
2500mm x 1250mm  
(8' x 4')

Extensive material  
library with optimum  
feed rates

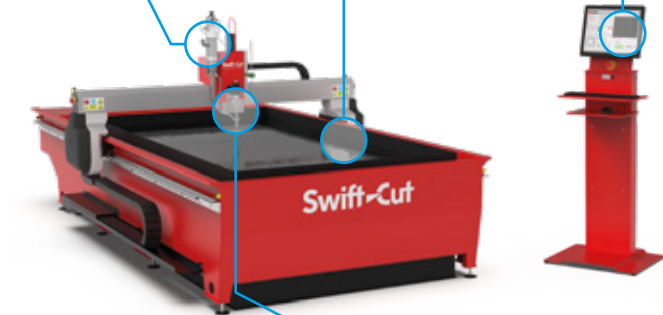

High/Low pressure control  
for piercing brittle materials



T3 is a true shared resource for the TransDev business divisions.

**TransDev**  
MANUFACTURING

**TransDev**  
SPECIAL BELTS

**TransDev**  
PLASTICS

## TRANSBACK

### Autoclaved Belt Backings

TransDev's autoclave cures rubber and polyurethane base belts with our range of specialist backing materials before any machining operations.

#### Endless Backings

##### Base Belts

- Rubber base belts
- Polyurethane base belts

##### Materials

- Natural rubbers (NR).
- Nitrile Butadiene Rubber (NBR).
- Carboxylated Nitrile Butadiene Rubber (XNBR).
- Hydrogenated Nitrile Butadiene Rubber (HNBR).
- Polyurethanes.
- Silicone Rubbers.

In addition to Autoclaved Backings we still offer standard Bonded Backings (Scarfe Joint).

##### Base Belts

- Rubber base belts
- Polyurethane base belts

##### Materials

- Natural rubbers, 38°, 55° & 70° Shore 'A' hardness's
- Nitrile rubber
- Polyurethanes, 60°, 70° & 80° Shore 'A' hardness's.
- Foams



## Injection Moulding

As well as injection moulding a range of pulleys, gears and belt profiles, TransDev moulds products for a wide range of industries.

TransDev has invested in modular tooling. This approach reduces tooling costs through the use of mould inserts, enabling a faster and more cost efficient project. If you have your own existing moulds we can also usually adapt these onsite to also save on costs.

TransDev's versatile injection moulding service is perfectly matched to your requirements. We can support short and long runs of product, whilst providing advice on the entire process; from inception through to delivery.

## TRANSMOULD

### Injection Moulding Materials

ABS	Acrylonitrile Butadiene Styrene	HDPE	High Density Polyethylene
ASA	Acrylonitrile Styrene Acrylonitrile	LDPE	Low Density Polyethylene
GPS	General Purpose Styrene	LLDPE	Linear Low Density Polyethylene
HIPS	High Impact Polystyrene	MDPE	Medium Density Polyethylene
LDPE	Low Density Polyethylene	HDPE	High Density Polyethylene
LLDPE	Linear Low Density Polyethylene	PA	Polyamide (Nylon 6, 6.6) Unfilled and Glass-Filled
MDPE	Medium Density Polyethylene	PBT	Polybutylene Terephthalate
HDPE	High Density Polyethylene	PC	Polycarbonate
PA	Polyamide (Nylon 6, 6.6) Unfilled and Glass-Filled	PC/ABS	Polycarbonate/Acrylonitrile Butadiene Styrene
PBT	Polybutylene Terephthalate	PES	Polyethersulphone
PC	Polycarbonate	PET	Polyethylene Terephthalate
PC/ABS	Polycarbonate/Acrylonitrile Butadiene Styrene	PMMA	Polyoxymethylene (Acetal)
PES	Polyethersulphone	POM	Polypropylene (Homopolymer and Copolymer)
PET	Polyethylene Terephthalate	PP	Unfilled, Glass-Filled and Talc-Filled
PMMA	Polyoxymethylene (Acetal)	PPO	Polyphenylene Oxide
POM	Polypropylene (Homopolymer and Copolymer)	PSU	Polysulphone
PP	Unfilled, Glass-Filled and Talc-Filled	PVDF	Polyvinylidene Fluoride
PPO	Polyphenylene Oxide	SAN	Styrene Acrylonitrile Copolymer
PSU	Polysulphone	SBS	Styrene Butadiene Styrene Copolymer
PVDF	Polyvinylidene Fluoride	TPR	Thermoplastic Rubber (Elastomer)
SAN	Styrene Acrylonitrile Copolymer	TPU	Thermoplastic Urethane (Elastomer)
SBS	Styrene Butadiene Styrene Copolymer		
TPR	Thermoplastic Rubber (Elastomer)		
TPU	Thermoplastic Urethane (Elastomer)		





# Timing Belts



## The smart way to manage your drive systems

Do you have to choose drive belts, fit them correctly and get the initial tension right? **Make Power Smart** - the new app from ContiTech puts the tools you need at your fingertips:

- Selecting the right belt
- Calculations
- Determining the initial tension
- Measurements for pulley alignment
- Measuring the drive geometry (wrap angle, center distance, pulley diameter)

...this is all with the help of a single app!

Keep your drive systems running more efficiently and for longer, whilst making all your decisions on the spot.



Visit the Continental website to download the app.

Continental

## SYNCHROCHAIN CARBON offers even more...

It is reassuring to know that the successor to the SYNCHROCHAIN standard belt brings even greater power and opens up more options for users and designers.

The CONTI® SYNCHROCHAIN CARBON belt produces up to 30% more power than its predecessor. Its superior strength is applicable in all mechanical and plant engineering fields.

A distinguishing feature of the CONTI® SYNCHROCHAIN CARBON is its intelligent design, with a combination of especially high-quality materials; light but durable Polyurethane for teeth and backing, high-tensile and longitudinally stable Carbon for the tension member, plus a specially coated, wear-resistant fabric. It therefore delivers clean, smooth, and dependable power transmission at high torques and dynamic loads.

CONTI® SYNCHROCHAIN CARBON is one of the world's highest-performance timing belts, thanks to its carbon tension member. This delivers higher power transfer, longer service lifetimes, little initial tension losses, and 50% less stretch than aramid.

For the same overall width, you get 5x higher power output. Overall belt width can be lowered by up to 80%, while maintaining the same power needs, resulting in lower overall system costs. When compared to heavy-duty timing belts made of Aramid cord, the service life is improved by up to 100%. Over the life of the belt, increased cord stiffness reduces early tension losses virtually to zero.

*TransDev holds one of the largest stock holdings of SYNCHROCHAIN belts in the market and can provide clear advice on the best belt options for your application. We still hold stocks of standard SYNCHROCHAIN belts, as well as SYNCHROCHAIN CARBON belts.*



## Sharing our Industry Know How

If you're looking for a component for a specific application or industry, our range of industry solution guides are designed to give you the information you need.

FOOD & BEVERAGE • AUTOMATED WAREHOUSES  
PLANT HIRE • SIGNAGE • HAUL-OFF

Download the latest guides at [www.transdev.co.uk/downloads](http://www.transdev.co.uk/downloads)



## DRIVEFLEX

### Key Steels and Parallel Keys

Keysteel is also known as Key Bar or Key Steel. TransDev has two standard lengths available: 12 inches (304.8mm) and 1 metre (1000mm).

TransDev Keysteels are available in a variety of widths and heights to suit all applications and are supplied as rectangular bars in C45 Steel to DIN 6880. Special (non-standard) sizes are also available; please inquire if the exact size you require is not listed. TransDev can also mill bars to size if necessary.

Parallel Keys from TransDev are designed to securely fasten pulleys, sprockets, and gears to rotating shafts. They also serve as a failsafe, providing cost-effective

protection for more expensive and critical components. As a result, it is critical to replace them on a regular basis.

Because Parallel Keys require a keyway to be installed, you can easily request that a keyway be cut when ordering Driveflex pulleys, gears, and sprockets. They can also be used in conjunction with the Driveflex Taper Lock Bushes. Our Special Manufacturing department can custom manufacture or rework Parallel Keys in addition to cutting keyways.

NEW



CALL US  
TO ORDER

T +44 (0)1202 675 555



## Bearings

### NEW DriveFlex Bearings



#### Driveflex Rod End Bearings

The Driveflex hardware range continues to expand with the addition of Galvanised Steel Rod End Bearings.

These popular products are also known as rose joints and come in male and female variants. Both types feature a circular head with an aperture and a connected shaft, with the male version having an external thread on the shaft and the female variant having an internal thread.

These mechanical articulating bearing joints are commonly utilised in industrial machinery for rotating, oscillating and linear motions. Manufactured from Galvanised Steel, they are maintenance-free and can be left or right hand threads.

#### Popular Metric Bearings & Spherical Plain Bearings

Driveflex Stainless Steel Popular Metric Bearings are available as standard and FDA versions, with fast deliveries from stock.

Spherical Plain Bearings are also stocked in standard and medium duty variants, with seals on both sides.

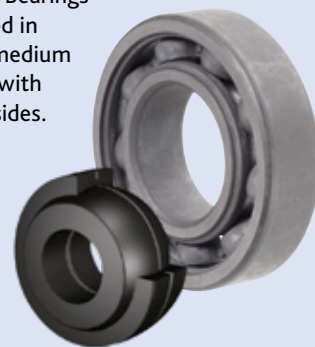

## DRIVEFLEX

### Coloured Thermoplastic Bearing Housings

Coloured Thermoplastic Bearing Housings include housings in a choice of 4 colours, with included protective End Cap and Stainless Steel Bearing insert.



They are ideal for food & beverage and pharmaceutical applications.

- Thermoplastic housing
- 4 colour options (White/Green/Blue/Black)
- Hygienic
- Suitable for low and high temperatures
- Chemical solvent resistant
- Durable and ideal for heavy loads
- Further metric and imperial sizes available
- Not supplied assembled





# Antistatic Belts Keep Industry Safe

Electrostatic charging is the physical process by which an excess shortage of electrons that cannot be compensated forms on non-electrically conductive surfaces. This potential difference usually does not pose a problem.

However, if this charge is compensated by flashover and therefore strong pulsed discharge currents, damage may occur on sensitive components. In explosive environments, such as petrochemical sites, these discharges may even pose a risk of ignition.

To protect electronic components in industrial environments from flashover, it is therefore required to continuously remove charge carriers (electrons) from the affected

surfaces. Electrostatic charging of belt drives is primarily the result of sliding friction on guide and support rails, friction in the tooth mesh and electric fields. As the thermoplastic polyurethane (TPU) makes timing belts excellent insulators, dissipation of charge differentials can pose problems. To give timing belts antistatic properties, i.e. allow them to discharge electricity, a conductive



material is mixed with the TPU. This creates

a slightly conductive compound such as **BRECO-TPU-AS1**, with a resistance of  $< 108 \Omega$ . Significantly lower

still resistance values are achieved by the TPU compounds **BRECO-TPU-AS2** and **TPU-AS7**. The latter is a recent development and offers particularly consistent resistance distribution in the longitudinal and transverse timing belt direction, as well as very low resistance values  $< 104 \Omega$ .

Another option for making timing belts conductive is coating the tooth and/or belt back with a conductive backing. The antistatic PA backing created by **BRECO** offers a resistance value of  $105 \Omega$  and is primarily used in belt drives serving as accumulating conveyors for electronic components. It also reduces the coefficient of friction to approximately 0.3.

## CONTI® SYNCHROFLEX

polyurethane timing belts are also available with antistatic properties. A special conductive polyurethane compound is available up to a belt length of 700 mm.



Alternatively, an electrically conductive backing can be sprayed on post-manufacture to all **BRECO**, **BRECOFLEX** and **SYNCHROFLEX** BELTS.

*Just ask our team for help with any antistatic belt queries*



## BEAM COUPLINGS - THE FACTS

- Hardware – Alloy Steel fixings with black oxide finish
- Multiple beam cuts improve parallel misalignment capabilities
- Constant velocity
- Flexible with low bearing loads
- Corrosion resistant Stainless Steels
- Aluminum is extra flexible with low bearing loads
- Lightweight for low inertia
- Temperature range:
  - Aluminium 7075:  $-40^{\circ}\text{F}$  to  $225^{\circ}\text{F}$
  - Stainless Steel:  $-40^{\circ}\text{F}$  to  $350^{\circ}\text{F}$
- Angular Misalignment = 3 degrees
- On assembly, shafts may enter up to  $0.5 \times L$  (length)
- Please be aware that shafts must not touch

**DRIVEFLEX**

Many sizes available from stock for next day delivery

PROJECT GALLERY

**TransDev**  
MANUFACTURING





## Plastics



# Plastics Targets Trade and Designers

TransDev is developing website pages to help promote its extensive range of display plastics from Irpen and Perspex plus machining options

The main aim is to provide a better home for the colourful and diverse ranges and to better address the specific needs and requirements of trade, designer and plastics users.

A series of articles on choosing, installation and care of plastics are there to reassure customers, whilst project images provide inspiration. The site is optimised to look great on mobile and provides essential information on light, thermal and colour matching properties at users fingertips.

Ultimately, TransDev remains an online distributor of plastics, with highly capable machining options and a local collection option for many customers based in Dorset and nearby.



Our team are happy to provide advice and help make your projects come to life.

THOUSANDS  
OF PRODUCTS  
ARE JUST A  
CLICK AWAY



- **UTILISE** the quick product search and easy navigation
- **VIEW** live stock availability and your agreed pricing
- **LINK** to product info
- **BUILD** and review order lists
- **SPECIFY** shipping type
- **MANAGE** your orders and users

**TransDev**  
DIRECT

[transdevdirect.co.uk](http://transdevdirect.co.uk)

Ask your TransDev Sales  
Contact for further details  
on our Trade Website

# THE NEW BIGGER BEAST

TransDev's industry leading motion catalogue, nicknamed the 'Beast', has grown even bigger.

Stuffed full of motion components, it introduces new product ranges as well as expanding existing ones. TransDev are already known for being the home of PU belts from leading manufacturers such as BRECO, Continental, Esband and Volta. However, in their latest catalogue (fondly nicknamed 'The Bigger Beast') they have added hundreds of new products across 1120 pages.

The TransDev catalogue features new sections for NTN and IKO bearings and linear products, Renold gearboxes, plus expanded ranges across BRECO, CONTI SYNCHROFLEX, SYNCHROCHAIN AND SYNCHROFORCE belts, hardware and more. As well as hosting 1000's of essential standard motion components, the 'Bigger Beast' also acts as the perfect introduction to TransDev's extensive custom belt, gear, pulley and sprocket manufacturing capabilities.



You can view a dynamic book, download a PDF or request a hard copy via our website.

## Christmas Shutdown

We would also like to take this opportunity to wish you, your family and your colleagues a Merry Christmas and a happy, healthy and prosperous New Year from everyone here at TransDev.

Date	Open/Closed
22nd Dec 2022	Normal hours 9.00 - 5.00
23rd Dec 2022 - 2nd Jan 2023	Closed
3rd Jan 2023	Normal hours 9.00 - 5.00

### Breakdown Service

During the shutdown period our **24/7 Premium Callout Service** will be operating as usual on **07850 548351** (Please note, the operator is unable to progress orders).



# THE BEAST JUST GOT BIGGER!

## WHAT'S NEW

- 1000+ pages of motion components
- New quick reference Technical Guide
- Hundreds of new products
- Even wider expanded ranges



NEW

Poly Vflex Rubber Belts

Thermoplastic Bearing Housings

Stainless Steel Hardware

Policril Acrylic Plastics

BRECO & BRECOFLEXmove Belts

Renold Gearboxes

Keys & Keysteels

Wippermann Low & Maintenance-free Chains

NTN-SNR Bearings

NTN-SNR & IKO Linear

Rigid & Beam Couplings

Rod End Bearings

Request your copy from your TransDev sales contact

To order or for more information:  
T +44 (0)1202 675 555

Transmission Developments Co (GB) Ltd  
Dawkins Rd, Poole, Dorset, BH1a5 4HF

**TransDev**  
THE POWER IN MOTION

BELTS  
PULLEYS  
CHAIN  
SPROCKETS  
GEARS  
LINEAR  
BEARINGS  
HARDWARE  
PLASTICS